

SUP: Special Use Permit 222 South Fremont St Staging for Construction at 200 South Fremont St

Presented by **Fremont Terrace
Associates**

VICTOR CATANZARO
650.574.1000
vic@wspre.com

REGAN CATANZARO
650.574.1000
regan@wspre.com

The information contained herein has been obtained from sources we deem reliable. We have no reason to doubt its accuracy but we do not warrant its accuracy. This information is for informational purposes only and should not be relied upon for any purchase or lease by the prospective buyer or tenant.

Truck Haul Route

Delivery Route to
Site
Truck Hauling Away
from Site

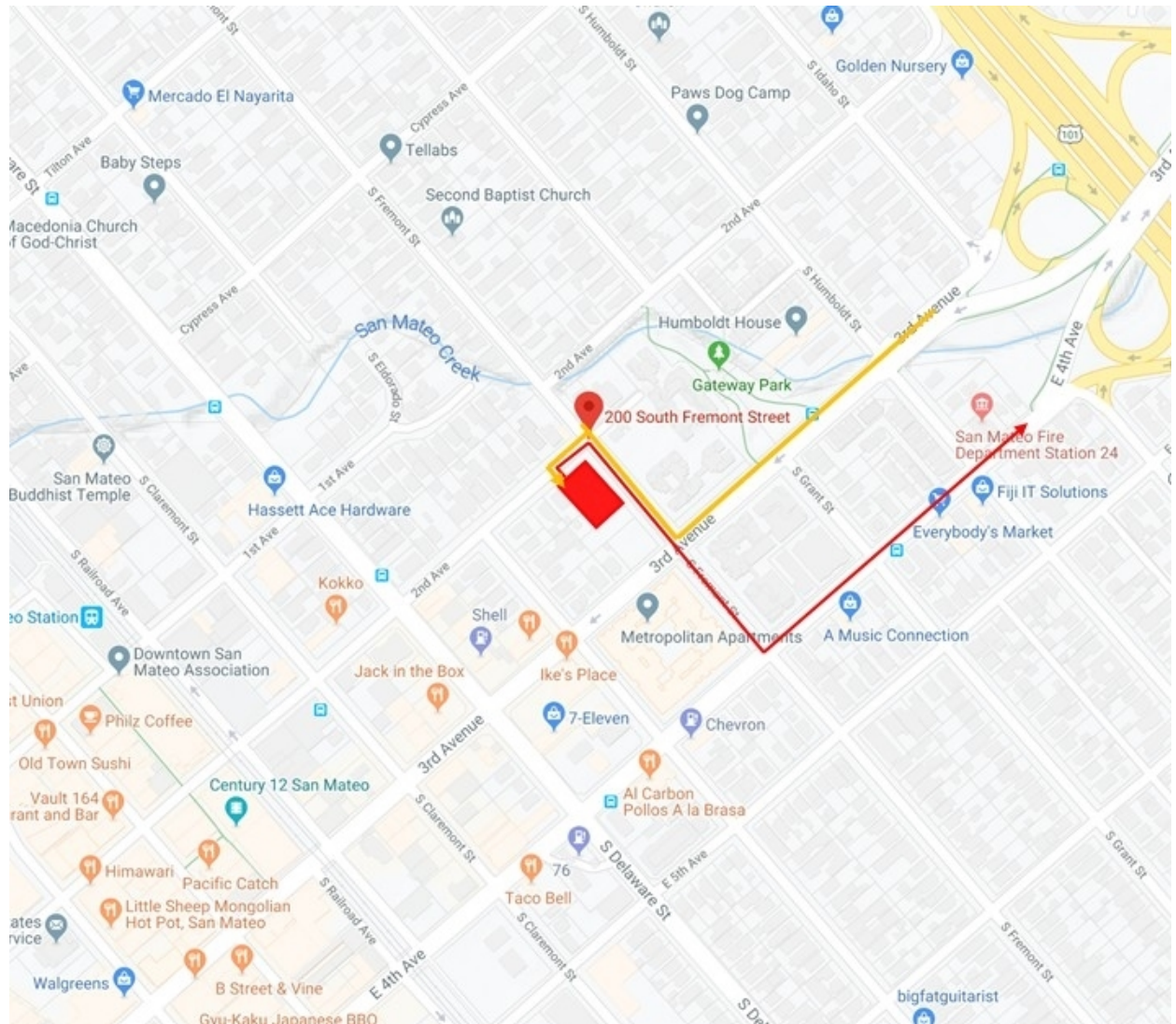

Presented by **Fremont Terrace
Associates**

VICTOR CATANZARO
650.574.1000
vic@wspre.com

REGAN CATANZARO
650.574.1000
regan@wspre.com

The information contained herein has been obtained from sources we deem reliable. We have no reason to doubt its accuracy but we do not guarantee it. All information should be verified prior to purchase or lease by the prospective buyer or tenant.

Construction plan for current site conditions through concrete form installation and concrete wall pour in below grade garage level:

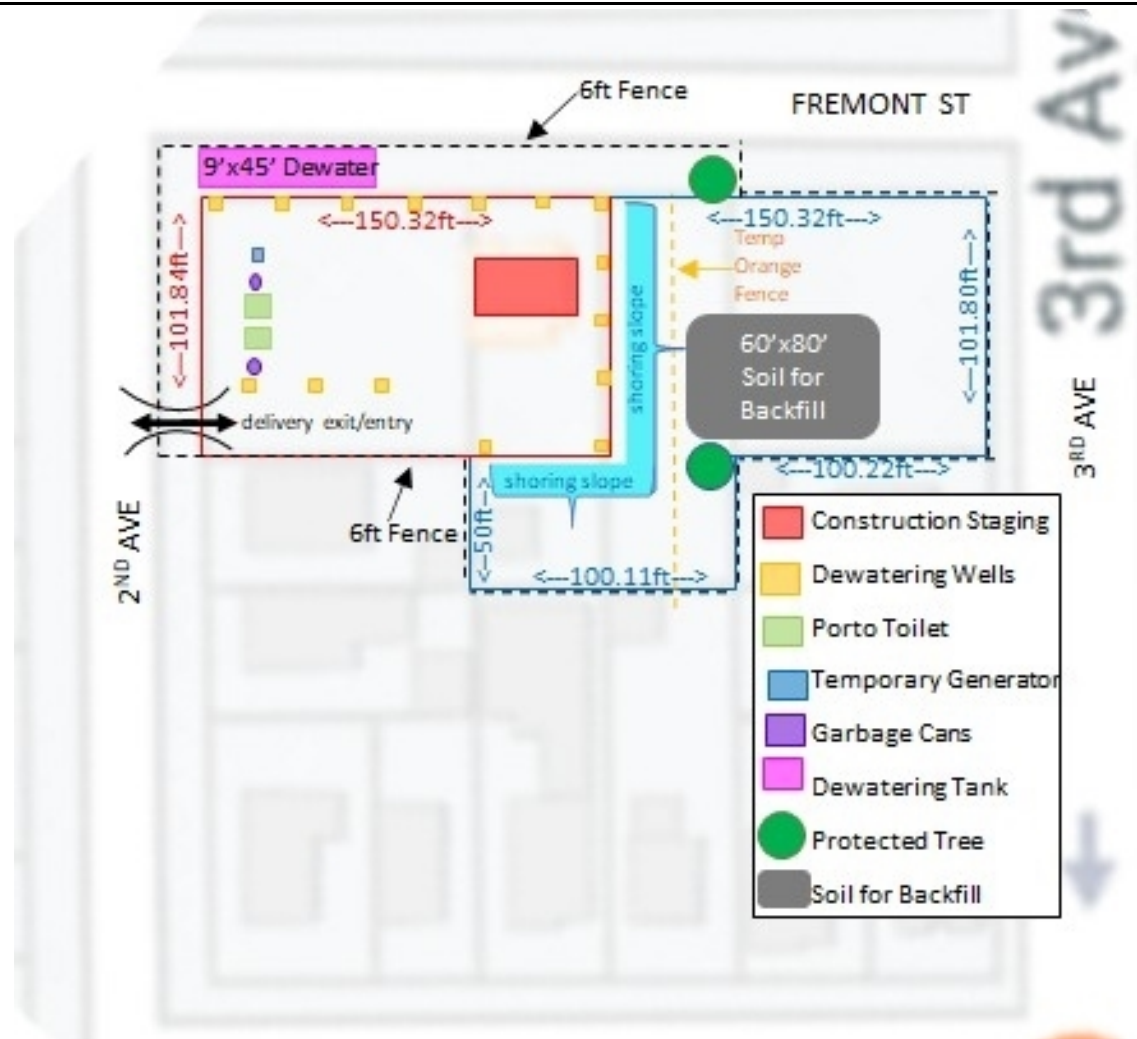

Presented by **Fremont Terrace Associates**

VICTOR CATANZARO
650.574.1000
vic@wspre.com

REGAN CATANZARO
650.574.1000
regan@wspre.com

The information contained herein has been obtained from sources we deem reliable. We have no reason to doubt its accuracy but we do not guarantee it. All information should be verified prior to purchase or lease by the prospective buyer or tenant.

Construction plan after soil is backfilled against below grade garage level

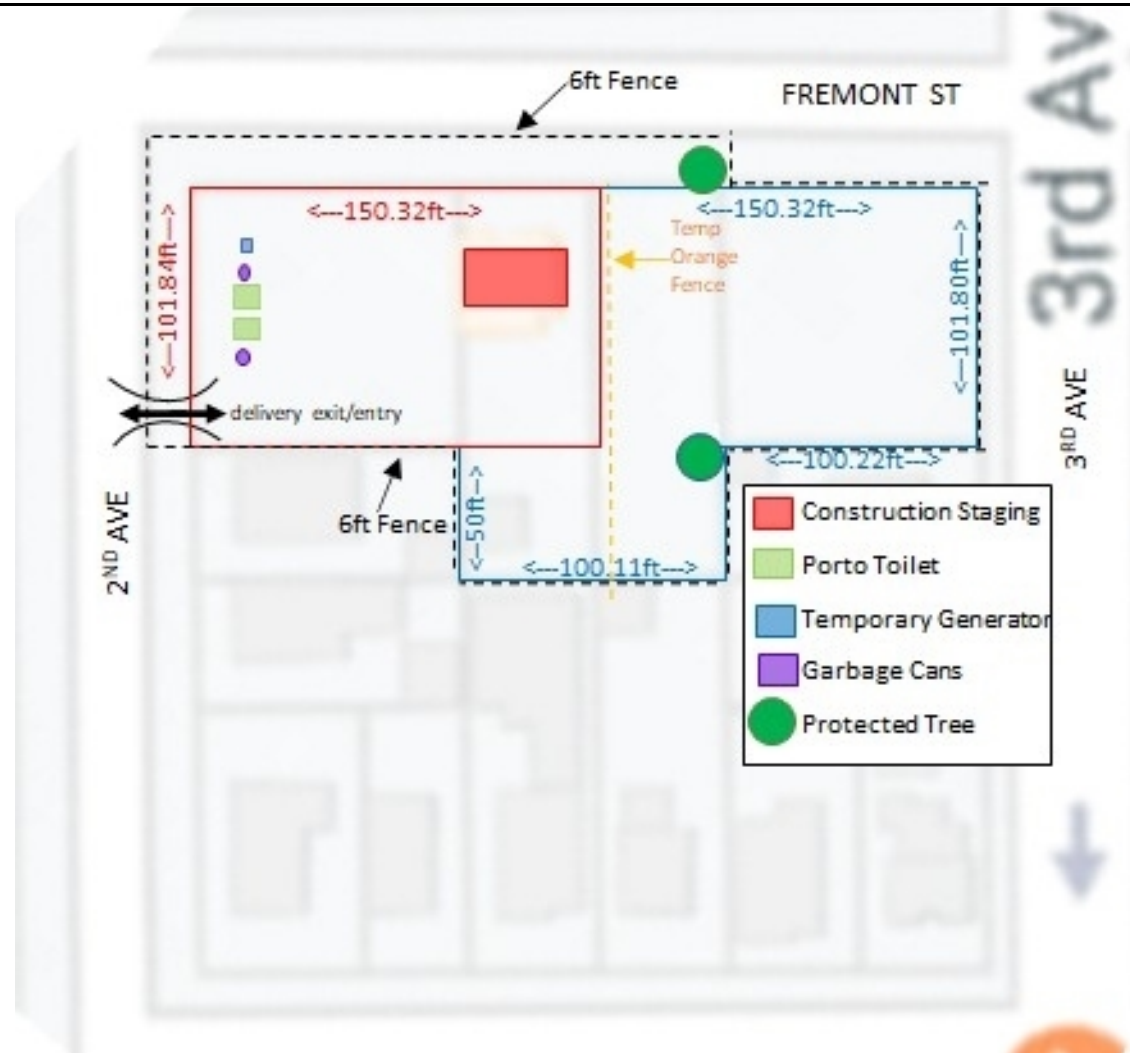

Presented by **Fremont Terrace Associates**

VICTOR CATANZARO
650.574.1000
vic@wspre.com

REGAN CATANZARO
650.574.1000
regan@wspre.com

The information contained herein has been obtained from sources we deem reliable. We have no reason to doubt its accuracy but we do not guarantee it. All information should be verified prior to purchase or lease by the prospective buyer or tenant.

Construction plan after SUP approval

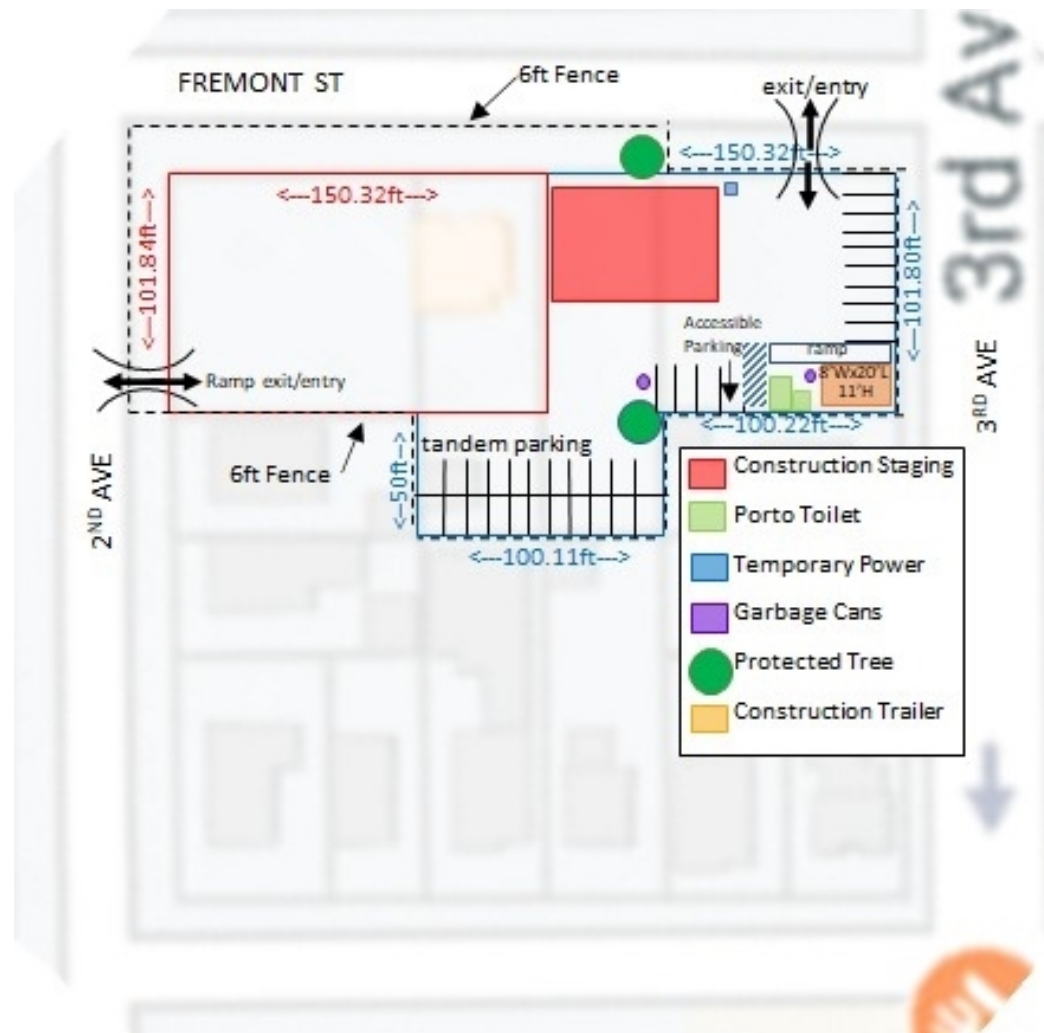

Presented by **Fremont Terrace Associates**

VICTOR CATANZARO
650.574.1000
vic@wspre.com

REGAN CATANZARO
650.574.1000
regan@wspre.com

The information contained herein has been obtained from sources we deem reliable. We have no reason to doubt its accuracy but we do not guarantee it. All information should be verified prior to purchase or lease by the prospective buyer or tenant.

South Delaware St

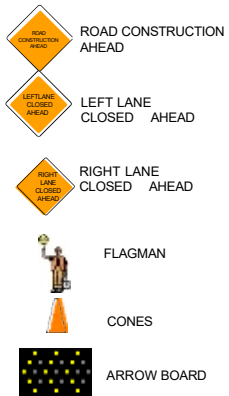

NORTH
H

South El Dorado

2nd Avenue

Page 13

East 3rd Avenue

6ft Fence

PRIMARY TRUCK
HAULING
ENTRANCE/EXIT

PARKING AREA

PROJECT SITE

PARKING
ENTRANCE/EXIT

20'
20'
st width 41 ft

st width 41 ft

15'
22'

st width 37 ft

South Fremont St

Not To Scale

Lawrence Ave

CONSTRUCTION ENTRANCES - PEDESTRIAN TRAFFIC MANAGEMENT PLAN

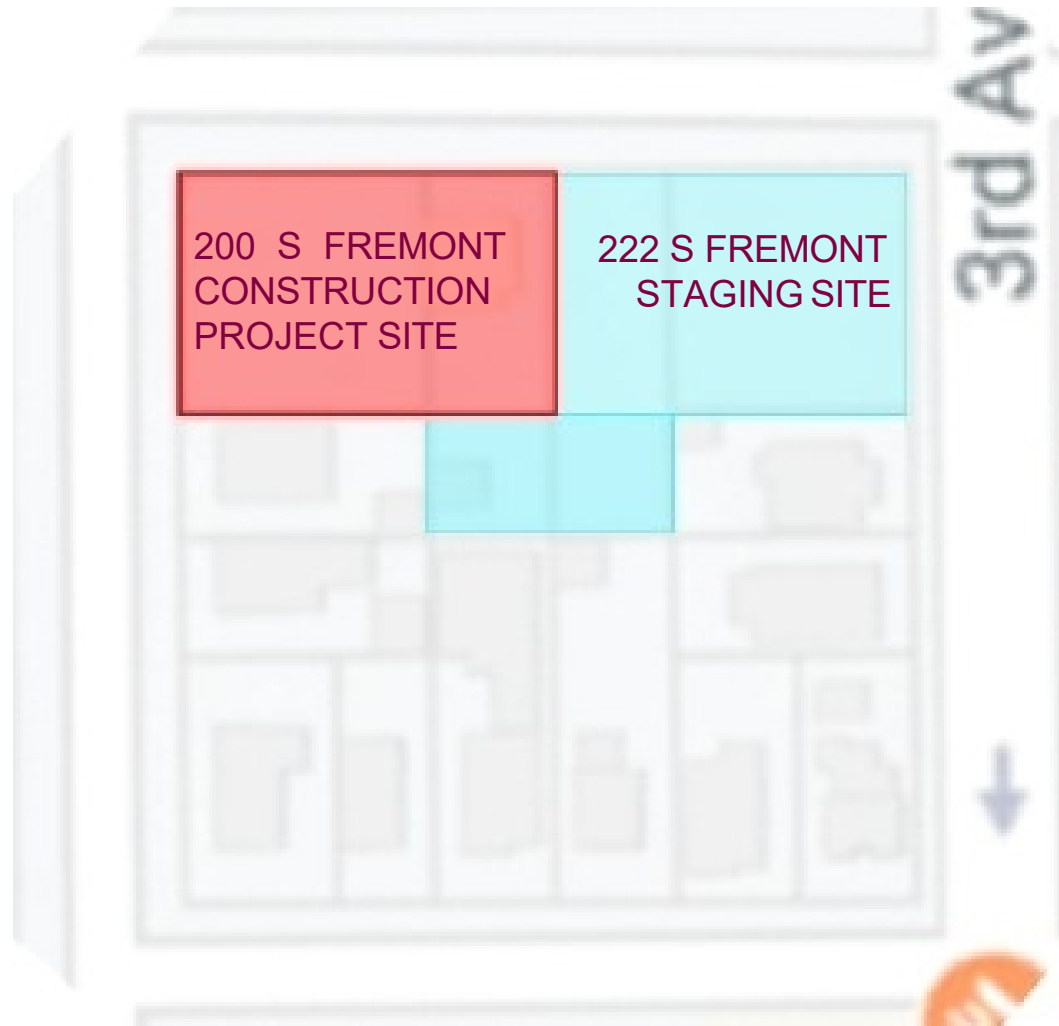

SUP: Special Use
Permit 222 South
Fremont St
Staging for Construction at
200 South Fremont St

Fremont Terrace
Associates

VICTOR CATANZARO
650.574.1000
vic@wspre.com

REGAN CATANZARO
650.574.1000
regan@wspre.com